

Olle

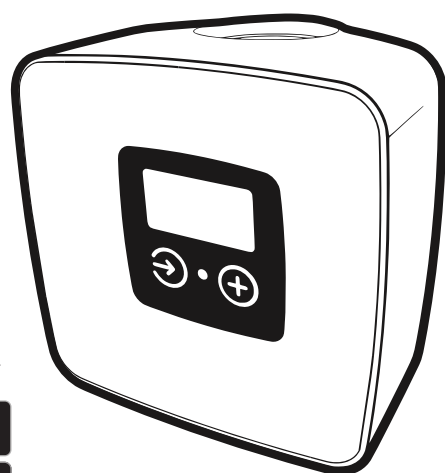

USER GUIDEBOOK

Cod.xxx | Manual revision 06/2017

PURPOSE OF THIS MANUAL AND GENERAL INFORMATION

The information in this manual accompanying the product is essential for the proper installation, use and maintenance of the heating system Olle and is updated at the date reported in the manual. Any updates or changes are found on the website <http://www.olleconnect.io>

The installation should be performed by qualified personnel and equipped with the necessary skills for this operation, with appropriate tools and in full compliance with all laws, rules and precautions on safety, as well as the requirements and guidelines in this manual. Failure to follow these information and the regulations contained in this document may lead to malfunction, failure, breakage, etc. and the danger of damage to property and/or persons, as well as forfeiture of the guarantee of AB Somatherm. In some countries the product can be approved for operation with the original components of the product, therefore, AB Somatherm recommends to use original spare parts or parts with completely equivalent technical and functional characteristics. The information was made by the manufacturer in the original language (Italian) to provide users with the necessary information to use the unit in a stand alone cost-effective and risk-free mode. AB Somatherm accepts no responsibility for any inaccuracies in this document due to printing errors or transcription. AB Somatherm reserves the right to make changes to information without the obligation to notify in advance, as long as they do not affect safety.

This document or any part thereof may not be copied, altered or reproduced without the written consent of AB Somatherm. Carefully store this manual for the entire life cycle of the product.

SAFETY WARNINGS

Most accidents are caused by failure to observe basic rules and safety precautions. AB Somatherm cannot foresee all possible circumstances that could involve potential dangers. The instructions in this guide, in the manual and on the product are, therefore, not all-inclusive. If in the various operations you adopt procedures, tools or methods that are not explicitly recommended by AB Somatherm it is essential to ensure that the work is performed in compliance with the safety of the performer and of others.

WARNING FOR USE

The product is designed to be easy to use, yet the use of the product by children and not suitable persons is recommended only under the supervision of an adult. The product is designed to be repaired by authorized personnel only. Do not perform any maintenance and replace damaged items. Do not pierce or carve. Do not place the product on heat. Do not wet the product in an attempt to clean it. Do not immerse in fluid. Clean the product with a dry cloth. Do not clean with aggressive products.

THE PACKAGE CONTAINS

Olle, cable cover, grommet, gland, gasket.

GLOSSARY

Pairing: it is the process that allows the App to connect the Towel Rail to the Smartphone or tablet.
Continuous mode: the Olle control drives the towel rail for a period of time, at a certain level of power
Timer mode: the Olle control drives the towel rail for a definite period of time, (e.g. 2h)

THE DISPLAY AND CONTROLS

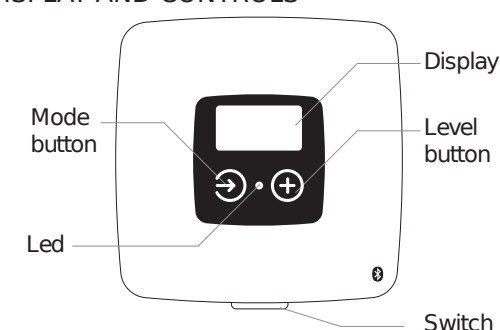

You can use Olle through the two buttons on the product or through the Olle Connect App from the store. The display shows the current status, and the daily energy consumption.

POWER SUPPLY

You can use Olle connecting to the domestic electrical grid the Live, Neutral and Ground wires (Class 1)

INSTALLATION

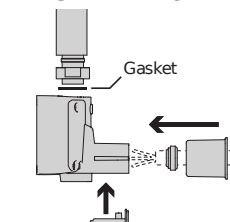

1- Insert the cable into the grommet. Connect the wires to the cable connector. Close the grommet at back, and close the bottom cover with the screws included in the package.

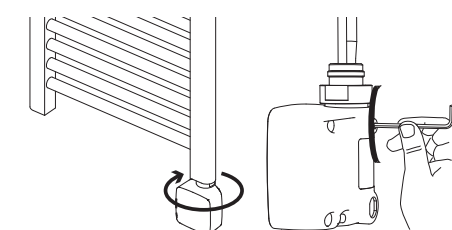

2- Connect the fastons to the heater. Connect the earth to the heater.
 3- Insert the gasket in the heater as shown in the figure.
 4- Screw Olle to the heater until it locks.
 5- Fasten Olle using the screw on the back. Use 1.5 mm Allen wrench (not included)

OLLE CORRECT POSITION

Olle can only be installed on towel rails. You can install it in the two positions shown in the figure.

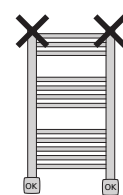

OLLE CONTROL

Olle is designed to control electric towel rail heaters filled with fluid (water or water+ glycol). The Olle control is compatible with the Somatherm heating elements.

FIRST START

To switch ON the Olle controller, turn on the switch located at the bottom of the controller. The controller starts up and the Standby mode symbol (U) will be shown on the display.

OPERATING MODES

With Olle you can control the Towel Rail in two distinct modes of use:

- Continuous mode
- Timer mode

Press the (U) button to select the operation modes:

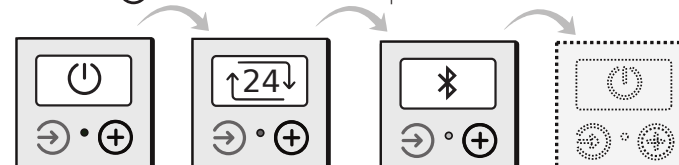

SELECTION BETWEEN CONTINUOUS MODE AND TIMER MODE

From Standby, press (U) button. The symbol (24) (Continuous Mode) will be flashing on the display. Within 3 seconds press the (+) button several times, and the following scheme will be followed:

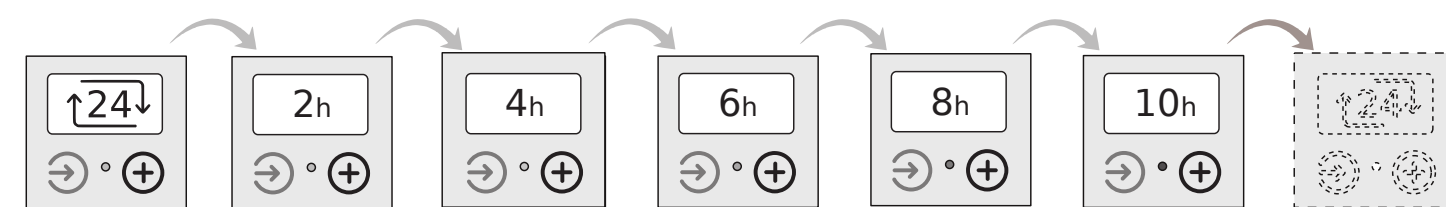

To confirm the operating mode desired between continuous mode (24) and timer mode (e.g. 2h, 4h, 6h, 8h), wait for 3 seconds and a buzzer will confirm automatically your selection. Then, the symbol heat power level will be flashing on the display.

SELECTION OF THE POWER LEVEL

As soon as the symbol heat power level (e.g., 20%) flashes, change the heat power level by pressing (+) several times according the following sequence:

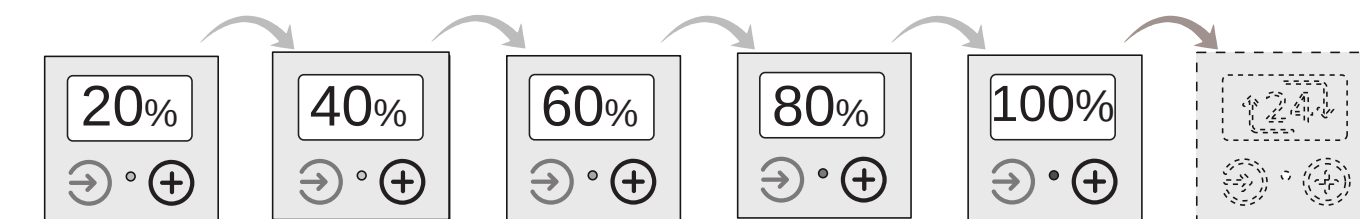

Levels of power with values 20%, 40%, 60%, 80%, 100% can be selected. The percentage values are referred to the towel rail power. To confirm the power level, wait for 3 seconds, and the buzzer will notify the selection. When the timer mode is selected, the (+) button is disabled.

EXIT FROM CONTINUOUS MODE AND TIMER MODE

Once an operation mode between Continuous and Timer has started, to exit and put the towel rail on Standby mode press (U) button.

QUICK ACCESS TO THE TIMER MODE

To select the Timer mode from the Standby mode (U) or Continuous mode (24), press the (+) button. The timer value will be shown, and a buzzer will confirm the selection. Once the selection is confirmed, the timer starts. When the timer mode is selected, the (+) button is disabled.

LED COLOR DESCRIPTION

LED	POWER LEVEL
Red	Power greater than 80%
Orange	Power between 60% and 80%
Yellow-orange	Power between 40% and 60%
Yellow	Power between 20% and 40%
Green	Power less than or equal to 20%

In case of system malfunction, Olle warns the user through a message on the display and the Led lights on the front panel.

Message	Description	What to do
Err 1	Loading error	Turn Olle off and let the heater cool down. Try to turn on Olle. If the error is no more present, the protection thermostat has operated. If the body of the towel rail is cold and the error persists, replace the heating element of the towel rail.
Err 3	Memory error	Data storage error: the weekly schedule may not work properly. Replace Olle control

PROCEDURE FOR LOCKING AND UNLOCKING KEYBOARD

To lock the keyboard of Olle, quickly press 3 times the standby button.
 To unlock the keyboard: quickly press 3 times standby.

RESET PROCEDURE

From Standby, scroll to Bluetooth with change mode button, then tap the level button (+) once, and the reset selection will appear. Confirm the reset.

CLEANING THE PRODUCT

To clean Olle, use a dry cloth. Do not clean with aggressive products. Do not wet the product in an attempt to clean it. Do not immerse in fluid.

TROUBLE SHOOTING

- Olle stops functioning: First, make sure that the Voltage power supply is correct and that the towel rail is properly fed. If the problem is of a different nature, contact technical support.
- The towel rail does not heat: Make sure the Olle is properly installed, that it is not set in the stand-by mode or that the room has not reached the set-point temperature set on Olle. If the problem persists, contact technical support.
- Towel rail is not powered: Upon restoration of the mains voltage, in case of absence of power for less than 6 hours, the radiator automatically recognizes the connection to Olle which was previously associated. Otherwise, re-set time and date and the desired program.

TECHNICAL DATA

Maximum output power	8 00W
Operating temperature	0 to 50°C
Storage temperature	-20 to +70°C
Operating humidity	0-80% non-condensing
IP Protection class	IP44
Insulation class	Class I

Material	ABS Bayblend
Dimensions	63mm x 63mm x 56mm
Weight	170 g

STANDARDS REFERENCE

SAFETY: EN 60950-1
 LVD: EN 60335-1; EN60335-2-30; EN60335-2-43 EN62333
 EMC: EN55014-1; EN55014-2; EN61000-3-2; EN61000-3-3; EN61000-3-4
 European Directives: 2002/96/EC and 2003/108/EC, 2008/34/EC WEEE, 2002/95/EC RoHS, 1999/5/EC R&TTE Directive, 2006/95/EC Low Voltage 2004/108/EC EMC

The declaration of conformity EC is available at the following

address:
www.olleconnect.io

WARRANTY

The product is guaranteed for three years from date of purchase against any manufacturing defects. The warranty is valid only in the presence of a dated purchase receipt.



DISPOSAL

at the end of its useful life the product must be disposed of according to the directives in force in the country where it is in use. The product has electrical and electronic components that must be disposed of according to the European directives for WEEE.

CONTACTS

The Service Centre is at your disposal at the following contacts:
 INFO ADDRESS: info@olleconnect.io
 SERVICE ADDRESS: service@olleconnect.io
 WEB ADDRESS: www.olleconnect.io